

- \* INSTALLATION IS REQUIRED BY OTHERS.
- \* ALL EDGES TO HAVE 1/4" RADIUS MIN.
- \* MANUFACTURING TOLERANCE ±1/4".
- \* PRODUCT: QS-CLS167230P
- \* QUANTITY: \_\_\_\_\_
- \* CONCRETE COLOR: \_\_\_\_\_
- \* CONCRETE TEXTURE: \_\_\_\_\_
- \* SEALER: STANDARD GLOSS SEALER
- \* STD. 2" DIA. DRAIN HOLE
- \* STD. COLOR & TEXTURE OPTIONS

APPROX. WT. 1,111 Lbs.  
(CUSTOMER TO OFFLOAD IF OVER 8000 Lbs.)

Authorized Signature \_\_\_\_\_ Date \_\_\_\_\_  
By signing above or stamping this drawing "approved" or  
no exception taken" authorization is given to Quick Crete  
to produce this drawing as shown within a 1/4" tolerance.

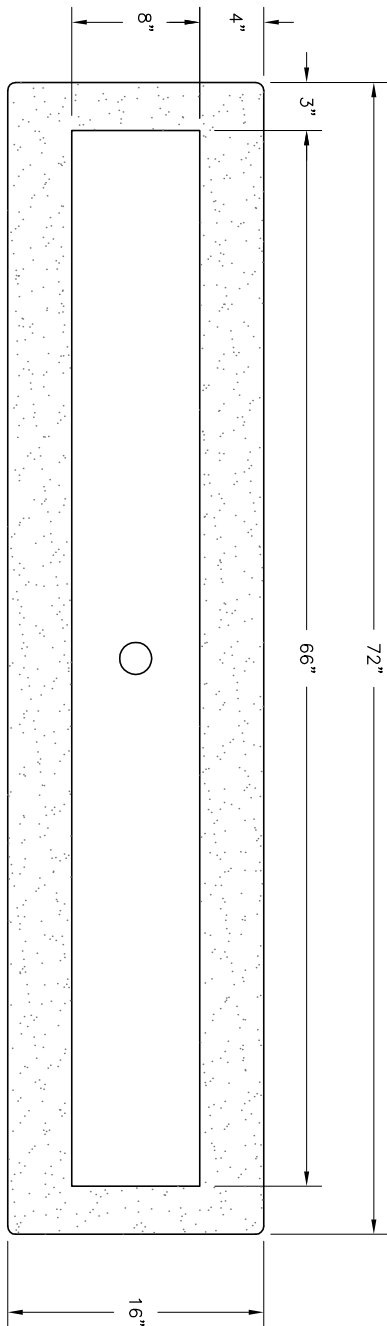

PLAN VIEW

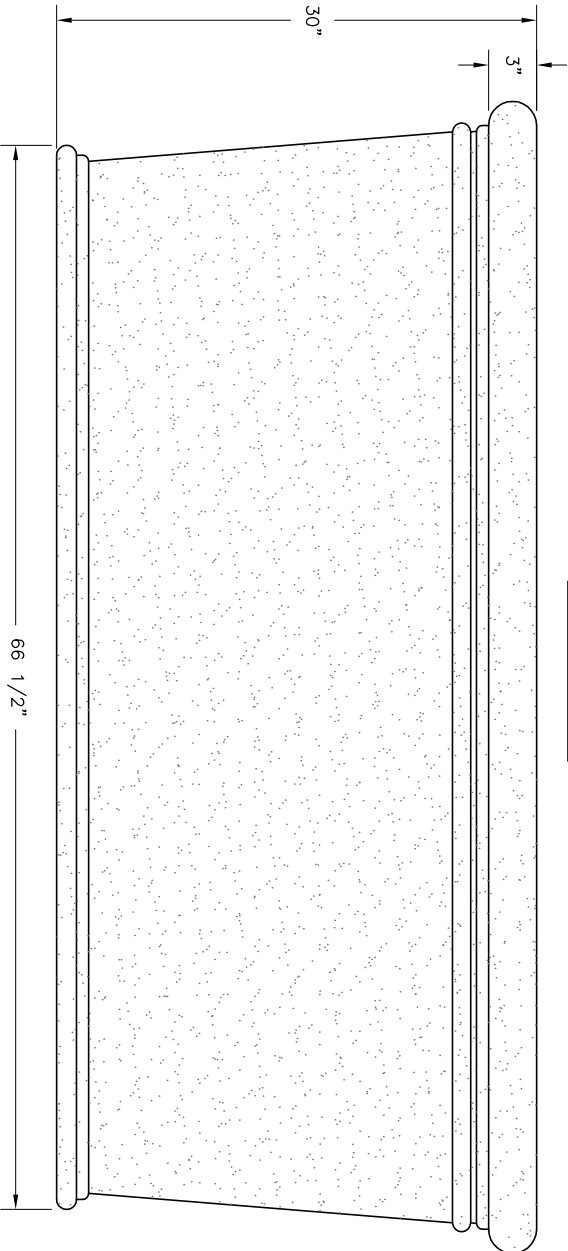

ELEVATION VIEW

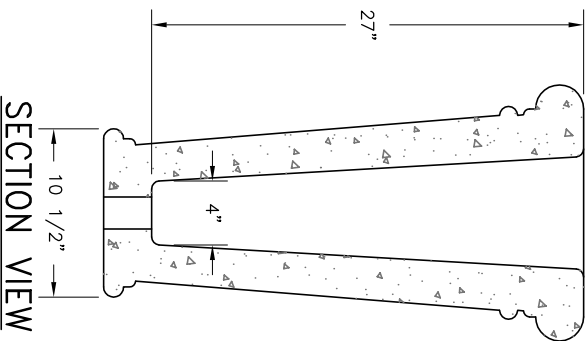

SECTION VIEW



**QUICK CRETE**  
PRODUCTS CORP.  
731 PARKRIDGE AVE.  
P.O. BOX 639  
NORCO, CA 92860  
(951) 737-6240 FAX (951) 737-703  
WWW.QUICKCRETE.COM

PLAN TYPE:	CONSTRUCTION PLAN	DATE:	3/6/02	FILE NO.	RECLS167230	SHEET	1	
PRODUCT:	CLASSIC REC. PLANTER (QS-CLS167230P)	SCALE:	1" = 1'	DRAWN BY:	J.U.	OF	1	
PROJECT NAME:								