

- \* INSTALLATION IS REQUIRED BY OTHERS.
- \* ALL EDGES TO HAVE 1/4" RADIUS MIN.
- \* MANUFACTURING TOLERANCE  $\pm 1/4"$ .
- \* PRODUCT: 36"DIA. x 24"HT. ASHFORD STYLE PLANTER
- \* QUANTITY: \_\_\_\_\_
- \* CONCRETE COLOR: \_\_\_\_\_
- \* CONCRETE TEXTURE: \_\_\_\_\_
- \* SEALER: STANDARD GLOSS SEALER
- \* STD. 2"DIA. DRAIN HOLE
- \* INCLUDE INTERIOR WATER SEALANT

- \* APPROX. WT. 419 LBS. (PLANTER)
- \* APPROX. WT. 102 LBS. (BASE)

Authorized Signature \_\_\_\_\_ Date \_\_\_\_\_  
 By signing above or stamping this drawing "approved" or  
 "no exception taken" authorization is given to Quick Crete  
 to produce this drawing as shown within a 1/4" tolerance.

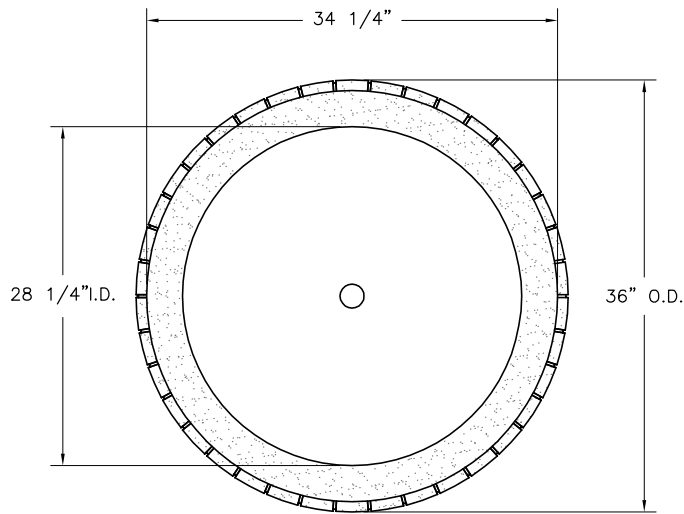

PLAN VIEW

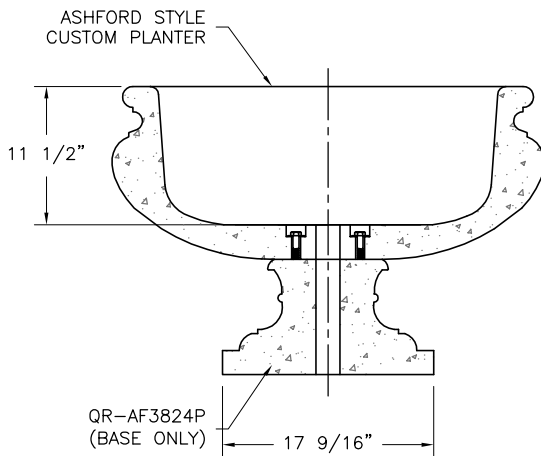

SECTION VIEW

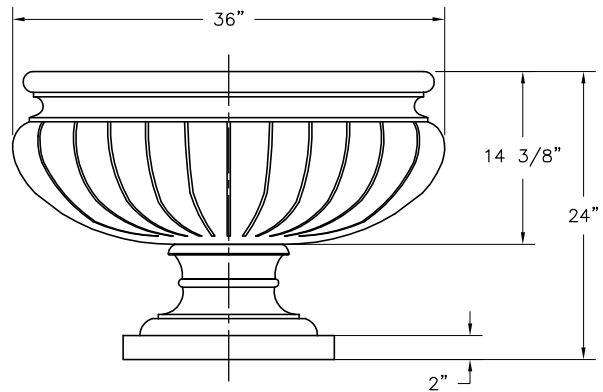

ELEVATION VIEW

K:\PLANTERS\ROUND-Pl\Ashford\AF3824P.dwg, 10/20/2008 7:01:07 AM

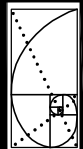

**QUICK CRETE**  
 PRODUCTS CORP.  
 731 PARKRIDGE AVE.  
 P.O. BOX 639  
 NORCO, CA 92860  
 (951) 737-6240 FAX (951) 737-7032  
 WWW.QUICKCRETE.COM

PLAN TYPE:	CONSTRUCTION PLAN
PRODUCT:	36"DIA. x 24"HT. ASHFORD STYLE PLANTER
PROJECT NAME:	

DATE:	3/31/07
SCALE:	3/4" = 1'
FILE NO.	
DRAWN BY:	

SHEET	1
OF	1